



Get in touch



Unit 16-17
Springvale Industrial Estate
off Union Street
Bilston
WV14 0QL

Phone 01902 491011
Fax 01902 492032

web: www.erconpowdercoatings.co.uk
email: sales@erconpowdercoatings.co.uk



Unit 15
Springvale Industrial Estate
off Union Street
Bilston
WV14 0QL

Phone 01902 405997
Fax 01902 498058

web: www.erconengineering.uk
email: sales@ercon-ema.co.uk



A safe pair of hands for all
your engineering projects



**TOTAL
ENGINEERING
SOLUTIONS**

www.erconengineering.uk
www.erconpowdercoatings.co.uk



ABOUT ERCON

Ercon Powder Coatings and Ercon Machining & Assembly are established family businesses that have been providing turnkey solutions to general industry for over 30 years.

At Ercon Powder Coatings and Ercon Machining and Assembly we offer a 48 hr turnaround for coating and 7 - 10 days for engineered products from receipt of materials into our factory.

If the arranging the logistics is a headache you can do without we are more than happy to offer our collection and delivery service.

We are located just off Junction 10 on the M6 so providing an ideal access point to locations around the country.

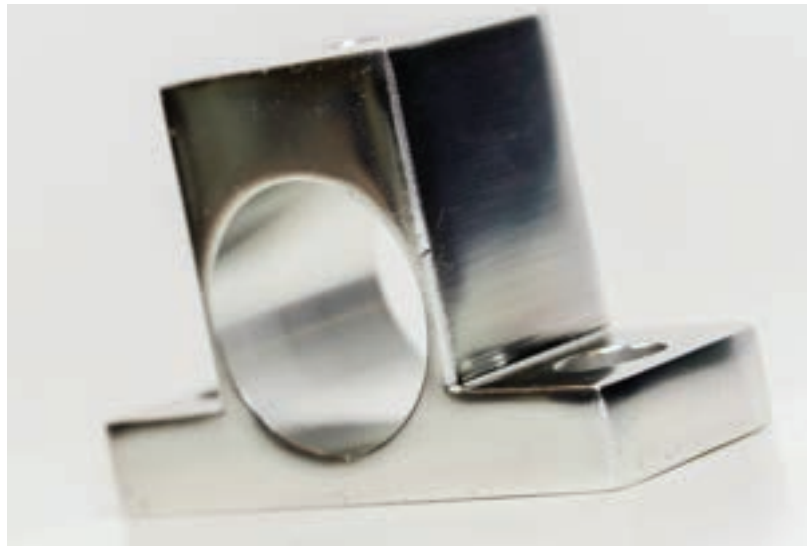

PLANT LIST

Our equipment and skills allow us to offer a wide range of services to industry from small prototyping work to scheduled production runs for turned components.

Our fabrication workshop produces a variety of parts from tables and chairs for offices, schools and fast food restaurants. Parts can be delivered self colour or we can arrange for them to be powder coated to a colour and texture of your choice through Ercon Powder coatings. We can produce parts from all materials such as Stainless steel, Mild steels, Aluminum, Brass, Nylon, Plastic etc. We are also happy to discuss stocking arrangements to ensure that we can deliver goods to you when you need them.

Ercon Powder Coating

- 2 x Overhead conveyor Automatic powder coating lines both with degrease Phosphate cleaning.
- Maximum work size 2000mm tall x 900mm wide x 4000mm long.
- Full range of BS and RAL colours and finishes to suit your requirements.
- 1 x off line booth for sample work.
- Bespoke packaging arrangements to suit your own specialised requirements.
- Jigs and fixtures.
- 48 hour turn around.
- Delivery and collection services available.

We service general industry and our customers range from 1st tier automotive suppliers to one off special projects and contract work.

Ercon Machining & Assembly

- 2 x 50mm diameter Emi - Mec machines with automatic loading.
- 2 x 26mm diameter Emi - Mec machines with automatic loading.
- 3 x production welding bays.
- 2 x milling machines
- 1 x universal milling machine
- Drilling and tapping services
- Capstan lathe
- 4M press
- Crush bending & piercing services.
- 3 x centre lathes.
- Specialist jig manufacturing.
- We can offer any finishing & plating services.
- Delivery and collection services available. contract work.



SUPPORT

You can get the level of support you need because we have the resource and infrastructure in place to deliver the speed and standard of care expected.

MISSION

The object of our company is to provide customers with a finished product and service of the highest quality and reliability, consistent with sound commercial practices and price. This is accomplished by the use of cost effective planning and procedures that maintain quality to specific standards with the aim of zero defects.



PHILOSOPHY

We foster a culture of innovation and a right first time approach. This way, you benefit from our attention to detail, confidence in our expertise and continuous improvement at every opportunity.



WHAT WE DO

Both Ercon Powder Coating and Ercon Machining & Assembly offer a wide range of engineering services, see our web sites for a full break down on what we can offer you.



ERCON POWDER COATING



Powder Coating

Powder coating is a finishing process that creates a tough finish.



Shot Blasting

Shot blasting is a key method of surface preparation to removing scale and rust.



Wet Spray

For a paint finish with a huge amount of durable applications to suit your specific needs.



Galvanising

A high level of protection afforded by galvanised coatings will safeguard steel against corrosion.



ERCON MACHINING & ASSEMBLY



Fabrication

Our coded welders are committed to providing the highest quality workmanship.



Machining

The ability to complete the machining in-house enables us to provide a rapid service.

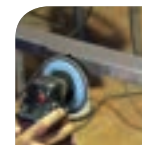

Finishing

Ercon offer a wide range of work requiring quality polishing and finishing.



Assembly

We can offer various contract assembly services and product assembly.



QUALITY

We operate in accordance with BS EN ISO 9001 standards and have full traceability of all parts through our processes. If any customer would require us to implement specialised quality systems for a particular project then our management team would be only too happy to assist.

We also operate a sound environmental policy which can be viewed upon request.